

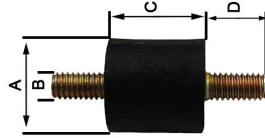

Rubber Vibration Insulator

Item ID	Stud Dimensions (In.)
A61519K	3/8 x 8-32 x 3/8

Used on Coleman motors. Four per package.



Rubber Vibration Insulators

Item ID	Dimension (In.)			
	A	B	C	D
A67804K	1	5/16	1	5/8
A67805K	1	1/4	3/4	1/2

4 per package.



Rheem Mounting Cables

Item ID	Length	For Motor
	(In.)	H.P.
A60325K	3 1/4	1/6
A60350K	3 1/2	1/4
A60378K	3 7/8	1/3



Conduit Box

Item ID	Motor Diameter (In.)
KIT142	3.3
KIT144	4.4-5.0-5.6

For universal design motors with conduit connector holes only.



Conduit Kit

Item ID	Brand
A60102	Packard

3/8" Conduit Connector
Allen Stevens type, complete with mounting screws. Packaged three per kit.



Conduit Fitting

Item ID	Brand
1202A	Century

For 4 5/16" diameter motors



Anti-Wind Brakes

Item ID	Diameter (In.)
A60012	1/2
A60058	5/8

Used to stop wind milling of rooftop motors.



Unit Bearing Motor Bracket

Item ID	Brand
A68004	Packard

Bracket for unit bearing motors.



Sand Screen

Item ID	Brand
A52008	Packard

Used in preparation for brazing, soldering and epoxy repairs 1 1/2" x 72" roll



90 Degree Plug And Cord

Item ID	Length (In.)
PLUG018	25

Used with unit bearing motors: plug and cord assembly
UL Recognized



Straight Plug And Cord

Item ID	Length (In.)
PLUG119	25

Used with unit bearing motors: plug and cord assembly
UL Recognized



Capacitor Mounting Kit

Item ID	Brand
A60010	Packard

Bracket dimension: 2 1/8" x 1 1/4" Cover dimension: 1 5/8"



Cap Guard

Item ID	Brand
A60000	Packard

Weather proofs capacitor connections by simply sliding on to the capacitor. Fits oval caps 2 thru 17.5MFD 370V and 2 thru 12.5MFD 440V. Sheet metal screws included.



Pitch Gauge

Item ID	Brand
PG5099801	Packard



Fan Blade & Blower Wheel Puller

Item ID	Brand
A89000	Packard



Hubs With Set & Mtg Screws

Item ID	Bore	Set Screws
H60765801	1/4"	1
H60765803	3/8"	1
H60765804	1/2"	2
H60765805	5/8"	2
H60765806	3/4"	2



Shafts 1018 Cold Rolled Steel Ground and Polished

Item ID	Diameter	Length
	(In.)	(In.)
S38220501	5/8	20
S38209601	3/4	20
S38269301	3/4	35
S38209501	1	25
S38249201	1	35



Capacitor Brackets

Item ID	Capacitor Length (In.)
A76501	4 3/8
A76502	3 3/8
A76503	2 3/4

For motor start capacitors.
5 per package.



Capacitor Brackets

Item ID	Diameter (In.)
A75400	1 3/4
A75500	2
A75600	2 1/2

For round motor run capacitors
5 per package.



Capacitor Brackets

Item ID	Dimensions (In.)	
	Width	Depth
A75100	1 5/16	2 5/32
A75200	1 29/32	2 29/32
A75300	1 31/32	3 21/32

For oval motor run capacitors.
5 per package.